

Exploded View for Durco / Flowserve Mark Series, Summit Clark Series, and other equivalents

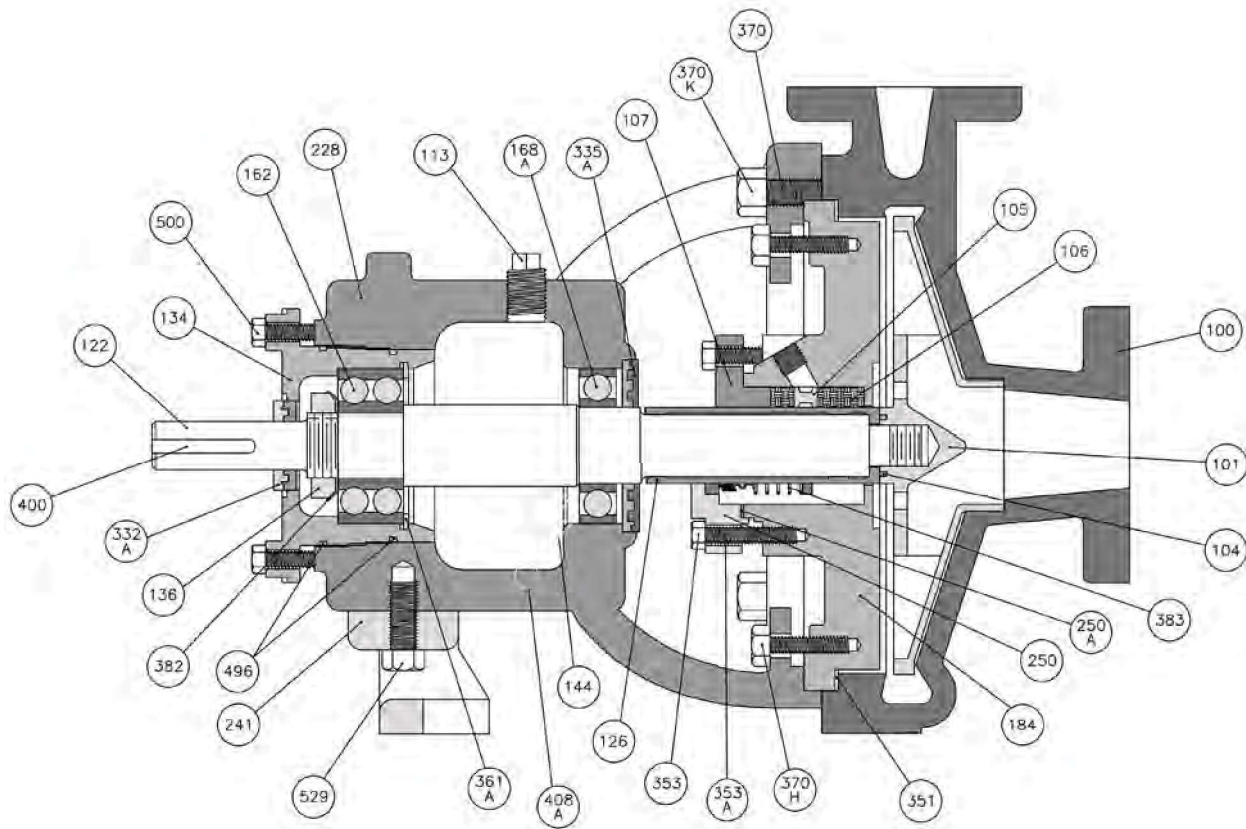

Group 1

Item #	Description	Item #	Description	Item #	Description
100	Casing	319	Sight Gauge	412A	Gasket (Impeller)
101	Impeller	332A	Laby seal (Outboard)	496	O-Ring (Bearing Carrier)
105	Lantern Ring	333A	Laby seal (Inboard)	500	Set Screw (Bearing Carrier)
106	Packing	348A	Oil Slinger (optional)	502	Bearing (Outboard)
107	Gland (Packing)	351	Gasket (Rear Cover)	503	Bearing (Inboard)
109	Foot (Bearing Housing)	353	Hexnut (Gland)	506	Retainer
113	Filler Plug	353A	Stud (Gland)		
122	Shaft	370	Bolt (Foot to Housing)		
126	Sleeve	370J	Stud (Casing)		
134	Bearing Carrier	370H	Capscrew (Cover/Adapter)		
136	Locknut (Bearing)	370K	Hexnut (Casing)		
184	Rear Cover Plate	382	Lockwasher (Bearing)		
228	Bearing Housing	383	Mechanical Seal		
250	Gland (Mechanical Seal)	400	Key (Shaft/Coupling)		
250A	Gasket (Gland)	408	Drain Plug		

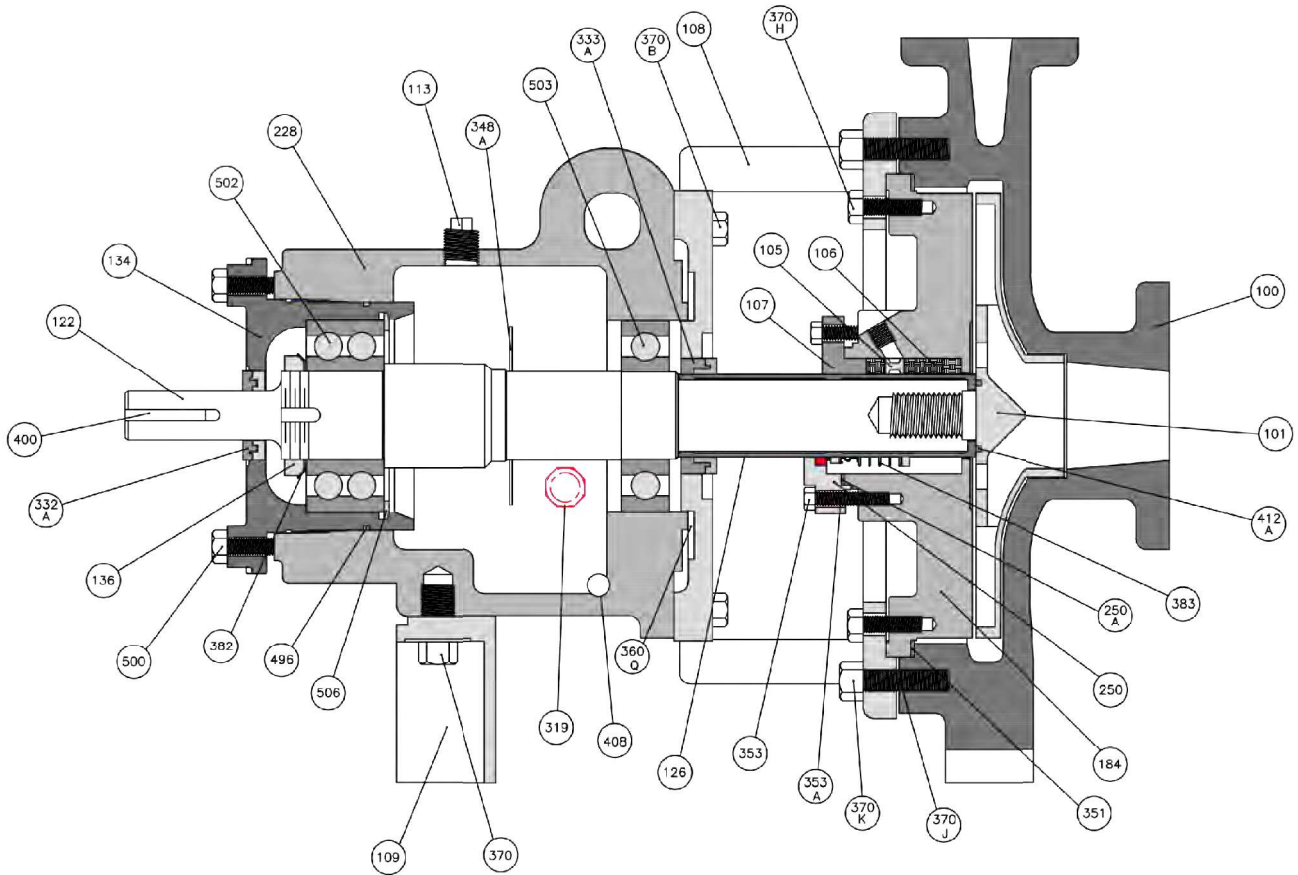

Group 2

Item #	Description	Item #	Description	Item #	Description
100	Casing	250A	Gasket (Gland)	383	Mechanical Seal
101	Impeller	319	Sight Gauge	400	Key (Shaft/Coupling)
105	Lantern Ring	332A	Laby seal (Outboard)	408	Drain Plug
106	Packing	333A	Laby seal (Inboard)	412A	Gasket (Impeller)
107	Gland (Packing)	348A	Oil Slinger (optional)	496	O-Ring (Bearing Carrier)
108	Adapter (Bearing Housing)	351	Gasket (Rear Cover)	500	Set Screw (Bearing Carrier)
109	Foot (Bearing Housing)	353	Hexnut (Gland)	502	Bearing (Outboard)
113	Filler Plug	353A	Stud (Gland)	503	Bearing (Inboard)
122	Shaft	360Q	O-Ring (Adapter)	506	Retainer
126	Sleeve	370	Bolt (Foot to Housing)		
134	Bearing Carrier	370B	Bolt (Adaptor to housing)		
136	Locknut (Bearing)	370H	Capscrew (Cover/Adapter)		
184	Rear Cover Plate	370J	Stud (Casing)		
228	Bearing Housing	370K	Hexnut (Casing)		
250	Gland (Mechanical Seal)	382	Lockwasher (Bearing)		

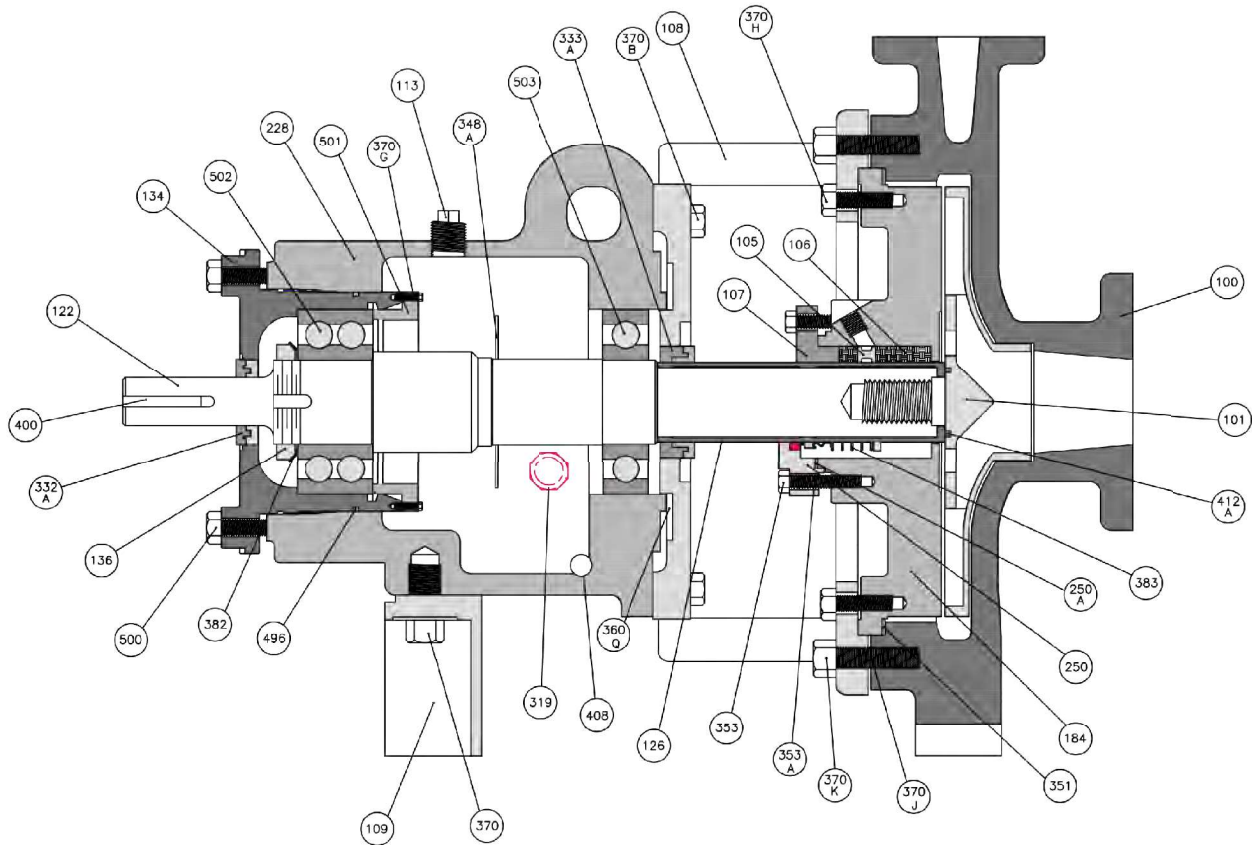

Group 3

Item #	Description	Item #	Description	Item #	Description
100	Casing	250A	Gasket (Gland)	382	Lockwasher (Bearing)
101	Impeller	319	Sight Gauge	383	Mechanical Seal
105	Lantern Ring	332A	Laby seal (Outboard)	400	Key (Shaft/Coupling)
106	Packing	333A	Laby seal (Inboard)	408	Drain Plug
107	Gland (Packing)	348A	Oil Slinger (optional)	412A	Gasket (Impeller)
108	Adapter (Bearing Housing)	351	Gasket (Rear Cover)	496	O-Ring (Bearing Carrier)
109	Foot (Bearing Housing)	353	Hexnut (Gland)	500	Set Screw (Bearing Carrier)
113	Filler Plug	353A	Stud (Gland)	501	Clamp Ring (Bearing Housing)
122	Shaft	360Q	O-Ring (Adapter)	502	Bearing (Outboard)
126	Sleeve	370	Bolt (Foot to Housing)	503	Bearing (Inboard)
134	Bearing Carrier	370B	Bolt (Adaptor to housing)		
136	Locknut (Bearing)	370G	Bolt		
184	Rear Cover Plate	370H	Capscrew (Cover/Adapter)		
228	Bearing Housing	370J	Stud (Casing)		
250	Gland (Mechanical Seal)	370K	Hexnut (Casing)		